

gia4life pendant

Description

The GIA4life Pendant provides you with a calming, body-worn bioenergetic solution to help you deal with everyday debilitating stress, including electromagnetic radiation (EMR). Stress acts as an age accelerator, and can also compromise our health, immune system, and our body's natural resistance to negative influences. The GIA4Life Pendant models employ the proprietary ERT technology to provide you with its unique energy enhancement qualities.



Benefits

- Energetically optimized with ERT to reinforce your body's natural resilience to the effects of everyday stress
- GIA4Life Pendant Models sold with FlexCore transferable insert
- Supports natural energy, plus mental & physical performance - especially under pressure
- Optimizes your capacity to perform in EMF/EMR-saturated environments

Available As

- Koru Pendant
- Heart Pendant
- Tag Pendant

Technology Used

- Energy Resonance Technology (ERT)

Includes

- Each GIA4life pendant is sold individually (chain not included) or in 5 piece Pendant Collection set
- Set includes Koru Pendant, Heart Pendant, Tag Pendant, FlexCore Insert and GIA4life Kay for transferring Flexcore insert to different models

Product Highlights

- Eight out of ten people say that when using the GIA4life Pendant(s), they feel significantly less stressed and much more balanced during the day

gia4life pendant - FAQ

Can I wear the GIA4Life Pendant in the shower?

Yes. All of the current GIA4Life Pendant models are waterproof.

Will the GIA4Life Pendant interfere with my pacemaker?

No, it will not. The Pendant is non-magnetic and safe to wear with your pacemaker.

If I feel uncomfortable when I first start wearing the GIA4Life Pendant, what should I do?

Take it off and put it in you pocket for one or tow hours per day. Increase to three to four hours a day the following week. After approximately 30 days, your body will adapt to the GIA4Life Pendant and you can start wearing it 24/7.

What if I don't feel any different within a few days of wearing the GIA4Life Pendant?

The GIA4Life Pendant is designed to reinforce your body's biofield. You may not always notice or feel this immediately. We suggest you wear the pendant for a month and then take it off for a day or two. Doing so will make the difference more apparent.

Does the GIA4Life Pendant contain a battery or any moving parts?

No batteries. The FlexCore insert is the only moving part and it can be transferred to each of the 3 GIA4Life Pendant models using the FlexCore Key (see diagram below)

How is the GIA4Life Pendant energetically entrained?

The Pendants are entrained in the Energy Elevation Chamber with GIA's proprietary Energy Resonance Technology (ERT), which is a highly effective, trade-secret protected process.

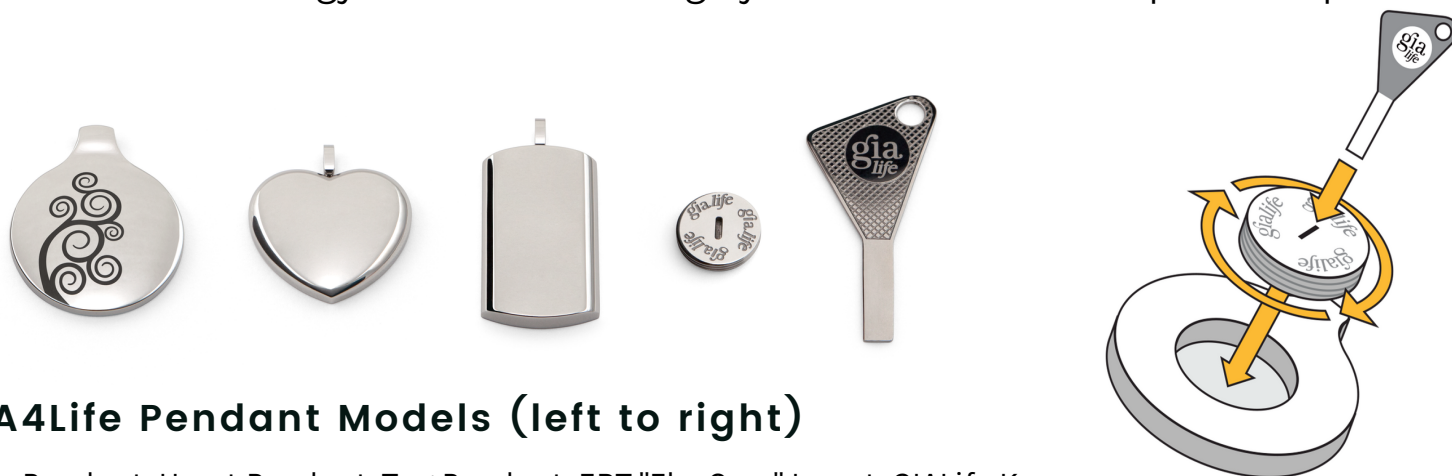

GIA4Life Pendant Models (left to right)

Koru Pendant, Heart Pendant, Tag Pendant, ERT "FlexCore" Insert, GIA4Life Key