

# SMART METER DEFENDER

## RADIATION PROTECTION PERFECTED



### AVAILABLE OPTIONS

Smart Meter Defender & Mesh Combo Pack (#39224)  
 Smart Meter Defender Only (#39222)  
 Optional Mesh Only (#39223)

### FITS THE 3 MOST COMMON TYPES OF SMART METERS

**Type A:** This is the most common type of Smart Meter found in North America. It has an exposed metal ring at its base and does not have a lock

**Type B:** This type of Smart Meter is similar to Type-A, but has a lock attached to its base

**Type C:** The metal ring at the base of Smart Meter Type-C is covered by the lid of the utility box

### KEY PRODUCT FEATURES\*

- **EFFECTIVE** Energy Resonance Technology (ERT) charged, radiation-shielding mesh material blocks 98%-99% of radiation emitted by your Smart Meter, while the remaining 1-2% is neutralized by GIA's patented MRET Technology
- **UNIVERSAL FIT** 7.125" diameter, rounded design fits virtually any Smart Meter type
- **EXTRA PROTECTION** Mount the (optional) mesh sheet on the indoor wall to defend against Smart Meter radiation both inside and outside your home
- **CRAFTED IN THE USA** Designed and hand-crafted in California by expert artisans using top-quality materials

Electromagnetic radiation (EMR) emitted by Smart Meters – many of them installed by utility companies without the consent of the home owner, tenant and/or business owner – have been linked to various stress-induced health issues. We are subjected to this overbearing external stressor every day. The GIA Smart Meter Defender allows for your Smart Meter to be used with the peace of mind you deserve. Utilizing radiation-inhibiting stainless steel materials coupled with the proprietary GIAplex technology, the GIA Smart Meter Defender actively works to neutralize the effects of your exposure to harmful radiation, while supporting the body's resilience to stress at the same time.\*



GIAplex™ combines the benefits of the patented noise field technology MRET™ (Molecular Resonance Effect Technology), and GIA's proprietary subtle energy technology ERT™ (Energy Resonance Technology). The combination of these two groundbreaking technologies offers an effective way to deal with the cumulative stress associated with living in today's electronic and wireless environment.\*

### Did you know?

*The World Health Organization (WHO) has classified radio frequency (RF) as a carcinogen (same as DDT and lead)! Military studies have shown that pulsed radiation can cause serious health problems, including tinnitus, memory loss and seizures. Countless studies have linked biological effects to RF radiation exposure, including increased cancer risk, damage to the nervous system, adverse reproductive effects, DNA damage, and more. Also, the American Academy of Environmental Medicine (AAEM) has contacted the California Public Utility Commission (CPUC), demanding a halt to the installation of wireless Smart Meters.*

### For more information contact:

\* Statements made about this product have not been evaluated by any governmental agencies. These products are not intended to diagnose, treat, mitigate, cure or prevent any disease. Any testimonials given reflect the actual experience of each individual, are anecdotal only, and may be atypical.



terragια™

www.giawellness.com

# SMART METER DEFENDER

## RADIATION PROTECTION PERFECTED

### FREQUENTLY ASKED QUESTIONS\*

#### How do I apply the GIA Smart Meter Defender™?

The installation of the Smart Meter Defender depends on the type of Smart Meter you have. The majority of Smart Meters are designed as one of three key types. The Smart Meter Defender works on all three of them. Step-by-step installation instructions, including explanatory drawings (as shown in the sample illustrations on the right), are enclosed with each Smart Meter Defender Package.

#### Can I move my GIA Smart Meter Defender from one Smart Meter to another?

Provided both Smart Meters are similar in dimension and type, yes, you may move the GIA Smart Meter Defender from one Smart Meter to another.

#### What is the lifespan of my GIA Smart Meter Defender?

The outer radiation shielding mesh material last for as long as the elements (wind, sun, snow, etc.) will allow it to last. The ERT-activation of the Smart Meter Defender is permanent. The patented polymer "Radiation Protection" decals incorporated in the Smart Meter Defender have a lifespan of two years, after which they should be replaced.

#### Will the Smart Meter Defender affect the signal strength of my Smart Meter (for meter readings by utility companies)?

The GIA Smart Meter Defender has been designed to neutralize the effects of your exposure to EMR, while leaving just enough of a signal for proper meter readings.

#### Is the Smart Meter Defender water and heat resistant?

Generally speaking, the Smart Meter Defender is water and heat resistant. However, it's safe to say that if your Smart Meter Defender is submerged in water for an extended period of time or were to inexplicably catch fire, you'll need to replace it.

#### What is the purpose of the optional stainless steel mesh sheet that I can additionally purchase with the Smart Meter Defender?

While the vast majority of the radiation emitted by Smart Meters protrudes forward (away from the base of the Smart Meter), there may be some small amount of residual radiation emanated on the opposite side of the Smart Meter base. The optional, ERT-charged, stainless steel mesh sheet allows you properly cover and protect the wall area on the opposite side of the wall to which the Smart Meter is mounted. Step-by-step installation instructions for the optional mesh sheet, including explanatory drawings (as shown in the sample illustrations on the right) are enclosed with each Smart Meter Defender Package.

### SAMPLE ILLUSTRATIONS OF INSTALLATION INSTRUCTIONS



#### SMART METER DEFENDER™ INSTALLATION INSTRUCTIONS

GIA's Smart Meter Defender will fit the majority of Smart Meters used in North America. Please determine your Smart Meter type below and follow the corresponding instructions for installation.

##### Type-A Smart Meter

**Tools Required:** Phillips screwdriver, adjustable wrench.

This is the most common type of Smart Meter found in North America. It has a recessed metal ring at its base and does not have a lock (Fig. 1-1).

Simply place the Defender over your Smart Meter and an attached mounting ring located at the Smart Meter's base (Fig. 2-1).

Tighten the screw on the bottom of the Defender to secure a snug fit.

**NOTE:** The mesh of the Smart Meter Defender is designed to stretch a little bit in the unlikely event that it doesn't fit over the metal ring located at the base of your Smart Meter. Simply remove the screw and run your finger over the Defender, carefully stretch it over your Smart Meter's base, and re-install the screw and run for a snug fit.

**QUESTIONS?** Please call GIA's friendly 1-800-Consultant Support at (760) 448-2468 or email us at [support@giawellness.com](mailto:support@giawellness.com).

##### Type-B Smart Meter

**Tools Required:** Screwdriver or wire clippers, Phillips screwdriver, adjustable wrench.

This type of Smart Meter is similar to Type A, but has a lock attached to its base (Fig. 1-2). The Defender has a built-in indentation designed to fit around your Smart Meter's lock. **NOTE:** It is recommended that you wear gloves for step 2 below to avoid pricking your fingers on sharp edges of the mesh material.

Find the notches at the base of your Defender.

Using a pair of scissors or wire clippers, cut the stainless steel mesh at each end of the rectangular indentation, then carefully bend the mesh upward (Fig. 2-2).

Line up the indentation on your Defender with the lock and slide it over your Smart Meter (Fig. 3-1).

Tighten the screw on the bottom of the Defender to secure a snug fit.

##### Type-C Smart Meter

**Tools Required:** Phillips screwdriver, adjustable wrench.

The metal ring at the base of Smart Meter Type C is covered by the lid of the utility box. With this type, your Defender will impact only down around the outer glass of your Smart Meter with help from the included rubber spacer (if you do not have a spacer, Smart Meter, please responsibly discard the spacer that is included with your order).

Peel the paper off the adhesive side of the rubber spacer.

Carefully apply the adhesive side of the spacer to the inside bottom rim of your Defender (Fig. 3-1). **NOTE:** Do not attach the spacer to the outer glass of the Smart Meter. Doing so will prevent access from your electrical utility company.

With the spacer now adhered, slide the Defender over your Smart Meter. It is usually flush with the inside of the utility box. **NOTE:** It is not necessary for the Defender to be 100% flush or to be actually touching the utility box (Fig. 3-2).

Tighten the screw on the bottom of your Defender to secure a snug fit. To avoid damaging the glass on your Smart Meter, be careful not to over-tighten.

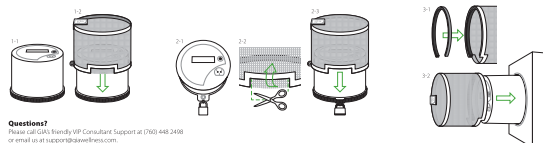

#### SMART METER DEFENDER™ RADIATION PROTECTIVE MESH SHEET - INSTALLATION INSTRUCTIONS

The ERT-charged Mesh Sheet is the optional companion product to GIA's Smart Meter Defender, helping to also combat any potential Smart Meter radiation on the inside of your home. See below on how to properly position and mount your Mesh Sheet:

##### Conceal

If you prefer, you may conceal the Mesh Sheet inside a decorative frame of your choosing, such as an appropriately sized picture frame from your local arts or framing store. Doing so will not negatively impact the performance of the Mesh Sheet. While the size of the sheet is 8.5" x 11" it may be trimmed down in order to fit smaller frames.

**NOTE:** Do not trim the sheet to a size smaller than 8" x 11". Doing so will prevent the Mesh Sheet from covering the entire base footprint of the Smart Meter. When trimming the Mesh Sheet, it is recommended that you wear gloves to avoid pricking your fingers on sharp edges of the mesh material.

1. Place the frame on a flat surface with the glass facing down.

2. Remove the backing of your decorative picture frame.

3. Insert a photo, certificate, or piece of artwork into the frame.

4. Insert the Mesh Sheet.

5. Insert the frame backing.

6. Mount the frame to the interior wall, using the "Position & Mount" instructions to the right.

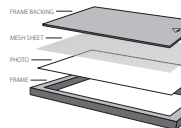

##### Position & Mount

Your goal here is to position the Mesh Sheet on your interior wall, so that it is lined up with the Smart Meter Defender outside. Here are your options:

**OPTION 1:** Request the help of a friend or partner.

1. With the help of a partner, identify the exact location of your Smart Meter and then mount the Mesh Sheet in the very same spot on the inside of their wall.

**OPTION 2:** If you are on your own, then:

1. Measure the distance between the corner point of your Smart Meter and the corner of the outdoor wall to which it is mounted.

2. Now measure the distance (the height) between the ground and the center point of your Smart Meter. Make sure to write down each measurement.

3. Using the previous measurements, now determine the center point of your Smart Meter on the interior facing side of that wall. Mark that spot.

4. Align the center point of the Mesh Sheet with the spot that you marked on the interior wall.

5. Mount the Mesh Sheet onto your interior wall using the bottoming of your choice (nails, screws, etc.). If you wish, you may also conceal the Mesh Sheet inside a decorative picture frame using the "Conceal" instructions to the left.

Covering the Mesh Sheet inside a decorative frame will not negatively impact its performance.

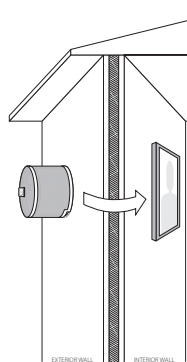

\* Statements made about this product have not been evaluated by any governmental agencies. These products are not intended to diagnose, treat, mitigate, cure or prevent any disease. Any testimonials given reflect the actual experience of each individual, are anecdotal only, and may be atypical.

